

440mm / 17" Mini Bar

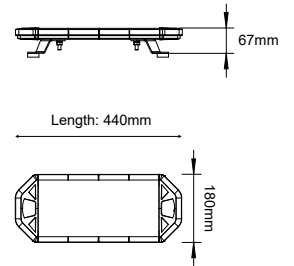

- . Aluminum Alloy Material Housing, PC lens
- . First Level: Warning Lights, 68pcs 2W LED Chip each color
- . Second Level: 50W White beam, can be used as a scene Light, take down, alley light.
- . By day, By night function, automatically adjust brightness
- . 5 Years Warranty, 10-30V
- . Single color has 15 flashing patterns, Dual color has 15x3 flashing patterns
- . ECE R65 Class 2, ECE R10, SAE J845 Class 1
- . Replaceable modules
- . 3 mounting ways in 1 (Screw Mount, Bracket mount, Magnets mount)

No.	Pictures	Colors	Cable	Mounting
L3- 440		First level: ● Amber Strobe Second level: ○ White beam	40cm cable (4 cores)	Screw Mount + Bracket Mount
L3- 440- 1		First level: ● Amber Strobe Second level: ○ White beam	3 meters cable	4pcs 66mm Magnets Tri- Cigarette plug
L3- 440aw- 1		First level: ●○ Amber + White Strobe Second level: ○ White beam	3 meters cable	4pcs 66mm Magnets Tri- Cigarette plug
L3- 440ab- 1		First level: ●● Amber + Blue Strobe Second level: ○ White beam	3 meters cable	4pcs 66mm Magnets Tri- Cigarette plug
L3- 440rb- 1		First level: ●● Red + Blue Strobe Second level: ○ White beam	3 meters cable	4pcs 66mm Magnets Tri- Cigarette plug