





INSTALLATION AND OPERATION INSTRUCTIONS

Specification

Size	: 236x80x37mm
Scene Light Power	: 32W
Warning Light Power	: 12W
Raw Lumen	: 3500LM
Scene Light Angle	: Down 45°
Warning Light angle	: Horizontal 180°
Waterproof	: IP6K9K
Flashing patterns	: 12 Patterns

ECE Approval	: ECE R65, ECE R10, R23
Other Approval	: CE, CA
Voltage	: 10-30V
Housing Material	: Aluminium Housing, PC Cover
Mounting	: Screw Mount
Cable	: 0.3M cable
Gasket	: Rubber

Wiring Instruction

Scene Light Positive		Red	(10-30V DC only, can be used as a reversing light)
Amber Strobe Positive		Yellow	(10-30V DC only)
Negative Ground		Black	
Flash Pattern and SYNC		Green	(Momentarily touch for next pattern, touch for 5 second go back to first pattern)
Asynchronous		White	

Synchronized Flash Setting

1. Connect all the **Green** wires together, and touch the **Green** wires to the positive for 5 seconds, and then all the lights will go back to the first flash pattern and will flash in SYNC.
2. Momentarily touch the **Green** wires to the positive for next pattern.

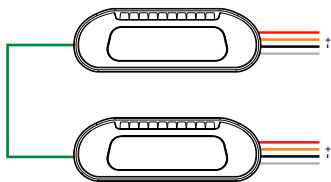

Asynchronous Flash Setting

1. Connect all the **Green** wires together, and touch the **Green** wires to the positive for 5 seconds, and then all the lights will go back to the first flash pattern and will flash in SYNC.
2. Momentarily touch the **Green** wires to the positive for next pattern.
3. Connect all the white wires of all the lights you want to be asynchronous to the positive +, and the lights will flash asynchronously.

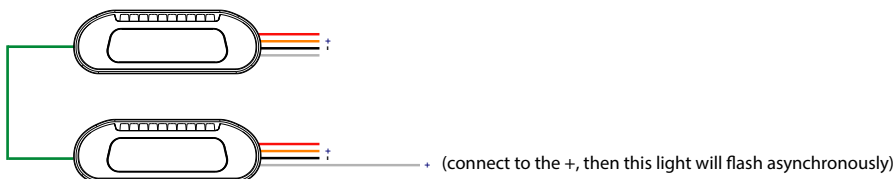

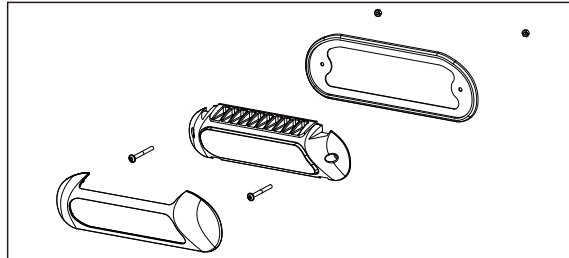
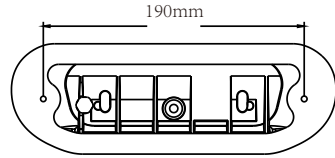
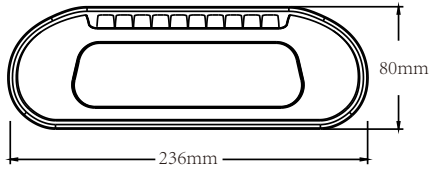

Flash Patterns

1	Single (R65)	7	Quintuple
2	Single	8	Combination Single/Double
3	Single	9	Combination Single/Triple
4	Double	10	Combination Single/Quintuple
5	Triple	11	Strobe
6	Quadruple	12	Cruise(30% Brightness)



- Only a qualified auto-electrician should install this product. Do Not install this product if unsure.
- Failure to use specified installation parts or hardware will void the product warranty.
- For this product to operate at optimum efficiency, a good electrical connection to ground must be made.
- Do not install and/or operate this safety product unless you have read and understand the safety information contained in this manual.

IMPORTANT! THIS UNIT IS A SAFETY DEVICE, AND IT MUST BE CONNECTED TO ITS OWN SEPARATE, FUSED POWER POINT TO ASSURE ITS CONTINUED OPERATION WHEN ANY OTHER ELECTRICAL ACCESSORY FAIL.